

UTILITY REQUIREMENTS AND SPECIFICATIONS

BETA STAR MODEL	STEAM (LB/HR) 60-80 PSIG	HIGH VACUUM WATER (GMP) 20-50 PSIG	COMPRESSED AIR (SCFM) 80-100 PSIG	DRAIN SIZE (INCHES)	STERILIZER CONTROL	VAC. SYSTEM
36 X 57 X 86	LINE SIZE 1 1/2 PEAK 900 AVG. 725	LINE SIZE 1/2 PEAK 4 AVG. 3	LINE SIZE 1/2 PEAK 3 AVG. 2	4	VOLTAGE 110 PHASE SINGLE FREQUENCY 60Hz AMP DRAW 5 EXT. WALL BOX WITH SWITCH DISCON. SIZE DISCON. FUSE SIZE 15 (AMP)	208V/3Ph/60Hz 480V/3Ph/60Hz
						AMP DRAW 17.5 DISCON. SIZE 30 DISCON. FUSE SIZE 20 AMP DRAW 7.6 DISCON. SIZE 30 DISCON. FUSE SIZE 10

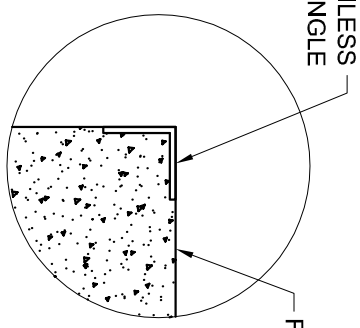
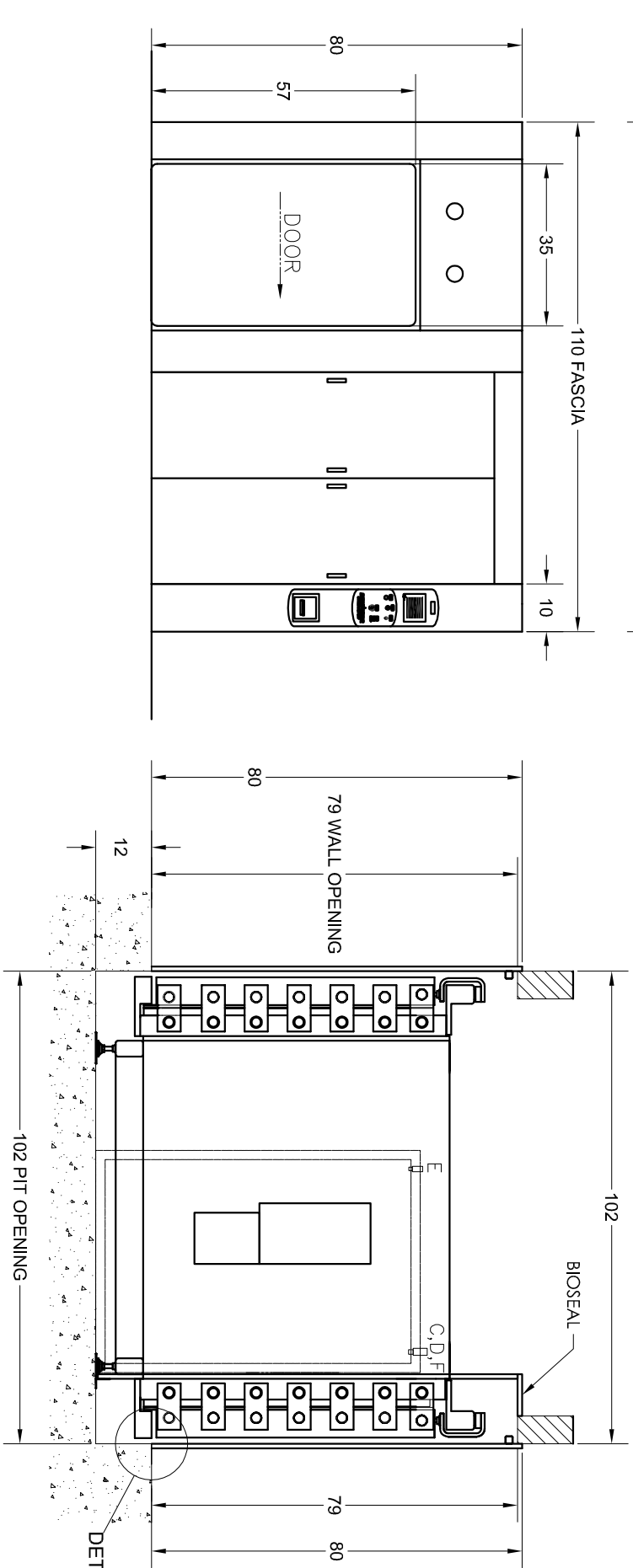
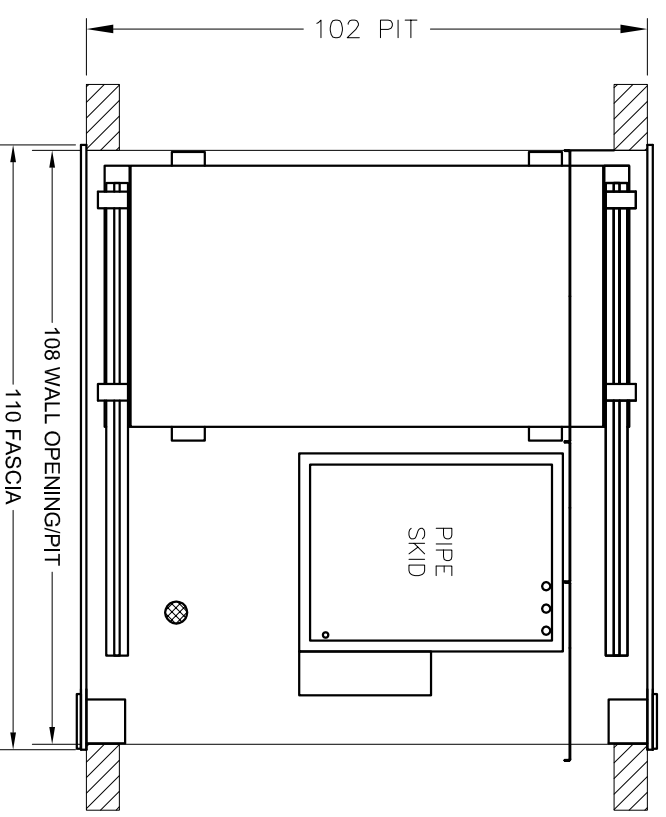

- NOTES:
- 1) UTILITIES SHOWN REQUIRE TIGHT SHUT OFF VALVE ACCESSABLE AT MACHINE FOR SERVICE.
  - 2) FOR LONG WATER OR STEAM RUNS INCREASE ONE PIPE SIZE TO INSURE PROPER GALLONS/HR & LB/HR FOR OPTIMUM EQUIPMENT PERFORMANCE.
  - 3) ALL UTILITIES MUST BE WITHIN 5 LINEAR FEET OF CONNECTION POINT OF STERILIZER.
  - 4) STEAM TO BE 97-100% VAPOR QUALITY AND BUCKET TRAP TO BE INSTALLED AT UNIT BY CUSTOMER.
  - 5) ENSURE A 2" MINIMUM AIR GAP BETWEEN DISCHARGE AND FLOOR DRAIN.
  - 6) EACH LINE ITEM ABOVE IS REQUIRED AS SEPARATE CIRCUITS.

12" X 12" FLOOR SINK WITH 4" DRAIN

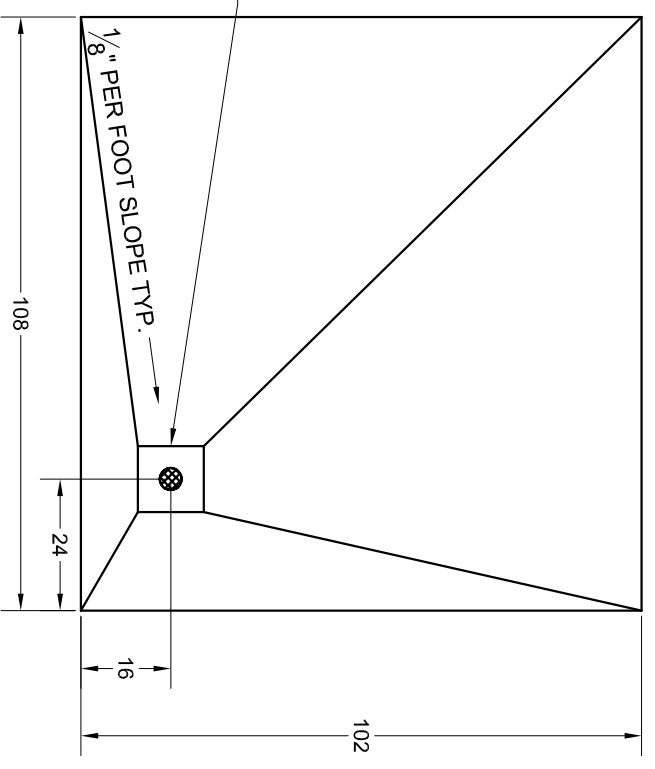

THIS DOCUMENT CONTAINS INFORMATION DEEMED CONFIDENTIAL AND PROPRIETARY TO R-V INDUSTRIES, INC. CENTRAL ENGINEERING & UTILITIES SERVICES AND MAY NOT BE REPRODUCED IN WHOLE OR IN PART WITHOUT THE EXPRESS WRITTEN PERMISSION OF R-V INDUSTRIES, INC. CENTRAL ENGINEERING & UTILITIES SERVICES. FURTHER NO USE OF THIS DOCUMENT OR THE INFORMATION CONTAINED HEREON MAY BE MADE WITHOUT FIRST SECURING THE PRIOR WRITTEN APPROVAL OF R-V INDUSTRIES, INC. CENTRAL ENGINEERING & UTILITIES SERVICES.

MACHINE TOLERANCES UNLESS OTHERWISE SPECIFIED	±1/32
X.X	±.020
X.XX	±.010
X.XXX	±.005
FRACTIONAL DIM ± 1/32	ANGLES ± 30 MIN
FABRICATION TOLERANCES	±1/16"
0" TO 36"	±1/8"
36" TO 120"	±3/16"
> 120"	
BREAK ALL SHARP EDGES	

0	9/17/07	ZAS	INITIAL RELEASE		
REV	DATE	DRAWN BY	REVISION	CHK	APP
DESCRIPTION: 35X57X86					
CUSTOMER:					
CUST. ORD. NO.					
CUST. REF. DWG.					
ITEM NO.					
584 POPLAR RD. HONEY BROOK, PA 19344 610-273-2457 FAX 610-273-2438					
Fought Weight: _____ Finish Weight: _____					
SCALE:	NONE	DATE:	9/17/07	DWG. NO.	B-88-20050
REV. 0 Sheet 1/1					